



YG Series Valve



ENGINEERING YOUR SUCCESS.

> INTRODUCTION

Parker YG series valves are Y pattern globe valves that are widely used in the power industry, petroleum, and chemical/petrochemical industries. With a maximum operating pressure of 414bar(6,000psi) and a maximum operating temperature of 676°C(1,250°F), the YG series valves are designed with a combined bonnet design to provide a stable sealing under high temperature and high pressure demanding working conditions. Two-stage stem/non-rotating head design effectively reduces the wear and tear caused by rotary motion on packing and seat, thus extending the packing and seat life and reducing operating torque. In addition, the packing is located below the stem thread, can prevent the thread lubricant contamination process medium, and also can remove the process medium to the lubricant erosion, thus effectively improve the lubrication effect of stem thread.

> SPECIFICATION

- 316H forging body.
- Maximum working pressure 414 bar(6000 psi).
- Maximum working temperature 676°C(1250°F).
- Butt weld or socket weld end.
- Orifice: 7.9mm.



> MATERIALS OF CONSTRUCTION

Item#	Description	Material
1	Body	ASTM A182, F316H
2	Packing	Reinforced Graphite
3	Bonnet Nut	ASTM A182, F316H
4	Hand Wheel	Cast Steel
5	Spring Washer	304SS
6	Nut	304SS
7	Plain Washer	304SS
8	Stem Assembly	316SS+440C
9	Bonnet	ASTM A479, 316H
10	Lock Nut	ASTM A479, 316SS
11	Packing	Graphite
12	Packing	Reinforced Graphite
13	Packing Nut	ASTM A479, 316SS
14	Stem Guide	ASTM A479, 316SS
15	Packing Washer	ASTM A479, 316SS
16	Bushing	ASTM A479, 316SS
17	Lock Pin	304SS
18	Retainer Ring	304SS

Note: more body and bonnet nut materials are available, please contact parker Hannifin if required.

> FEATURE

- Round handwheel with direction indication, easy to operate
- Forged body and bonnet nuts enhance reliability in harsh service conditions.
- Metal Wire-reinforced graphite packing, extended service life, suitable for high temperature and high pressure working conditions.
- The packing is located below the stem thread, can prevent the thread lubricant contamination process medium, and also can remove the process medium to the lubricant erosion
- Two-stage stem/non-rotating head design effectively reduces the wear and tear caused by rotary motion on packing and seat, thus extending the packing and seat life and reducing operating torque.
- Safety stop pin design to prevent accidental disassembly.
- Combined bonnet design of metal hard seal and soft seal, to provide a stable sealing under high temperature and high pressure demanding working conditions.
- Y-shaped body design provides better fluid mobility.
- Valve body and bonnet nuts have traceable material lot codes.

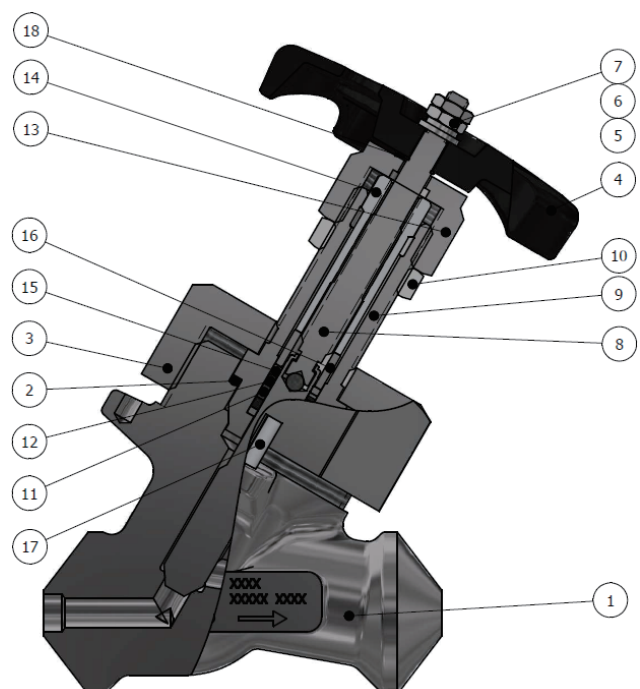

➤ PRESSURE VS TEMPERATURE

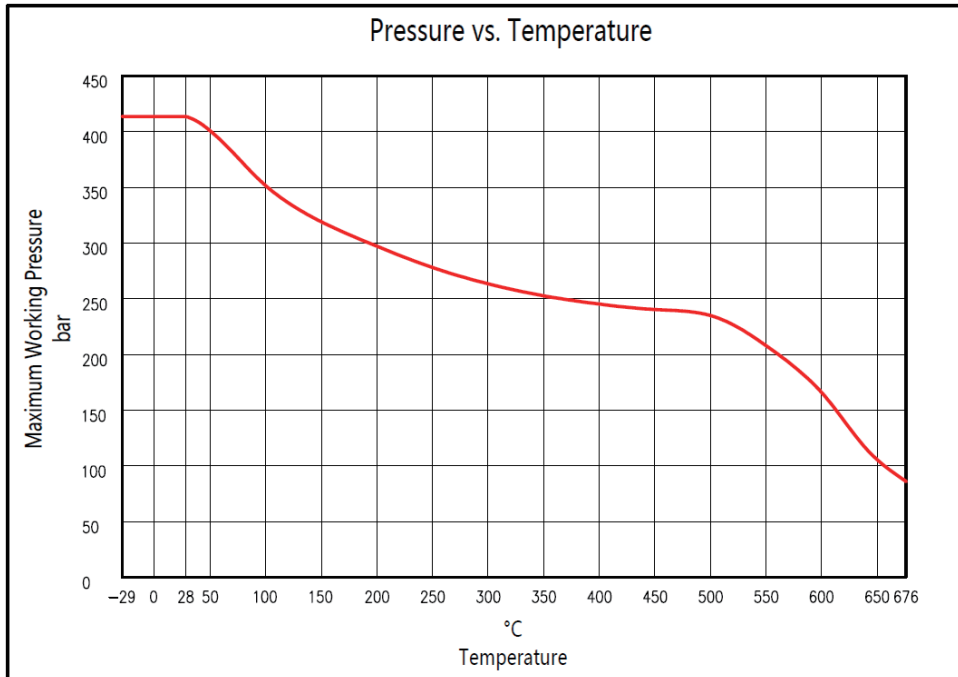

A182-F316H	
Pressure vs Temperature (2500LB)	
T(°C)	P(bar)
-29	414
38	414
50	401
100	352
150	321
200	297
250	278
300	264
350	253
400	245
450	240
500	235
550	208
600	166
650	106
676	86

➤ CONSTRUCTION DIMENSIONS

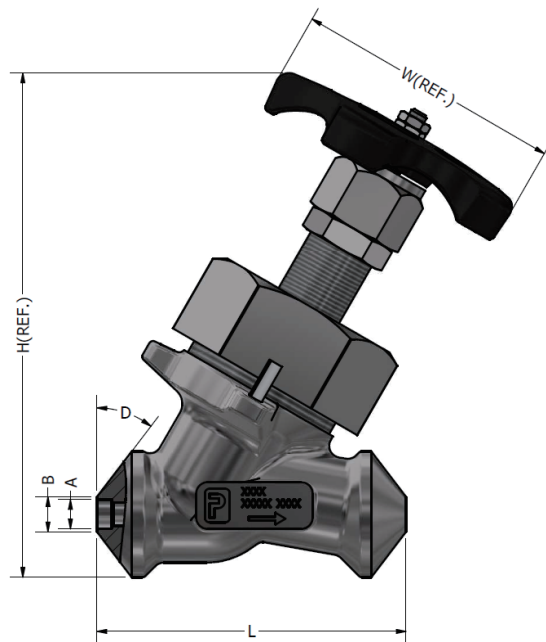

Butt Weld Type

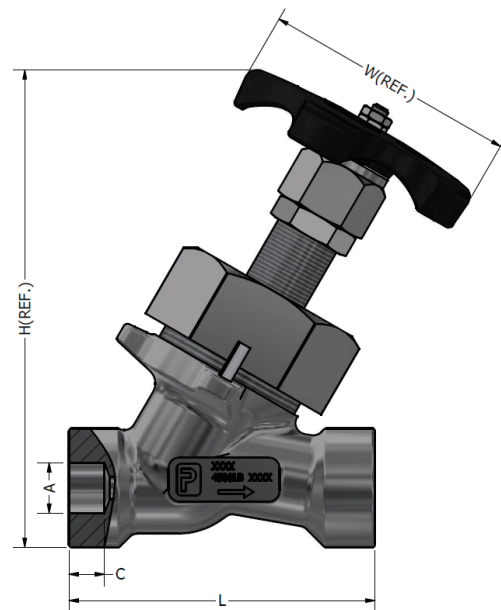

Socket Weld Type

P/N	ΦA mm	ΦB mm	C mm	D°	L mm	H mm	W mm
BW10-YG12-G-316H-2500	10	12	/	37.5	106	172	95
SW14-YG12-G-316H-2500	14.2	/	11.1	/	110	172	95
SW16-YG12-G-316H-2500	16.2	/	11.9	/	110	172	95
SW18-YG12-G-316H-2500	18.2	/	12.7	/	110	172	95

The dimensions in table are approximate, which may change. For more P/Ns and size requirements, please contact Parker Hannifin.

More pressure classes are optional, for more details please contact Parker Hannifin.

> HOW TO ORDER

The correct part number is easily derived from the following number sequence. The six product characteristics required are coded as shown below. *Note: If the inlet and outlet ports are the same, eliminate the outlet port designator.

Below example describes an YG Series needle valve equipped with 10mm ID tube butt weld inlet and outlet ports, graphite packing, stainless steel construction.

Examples:

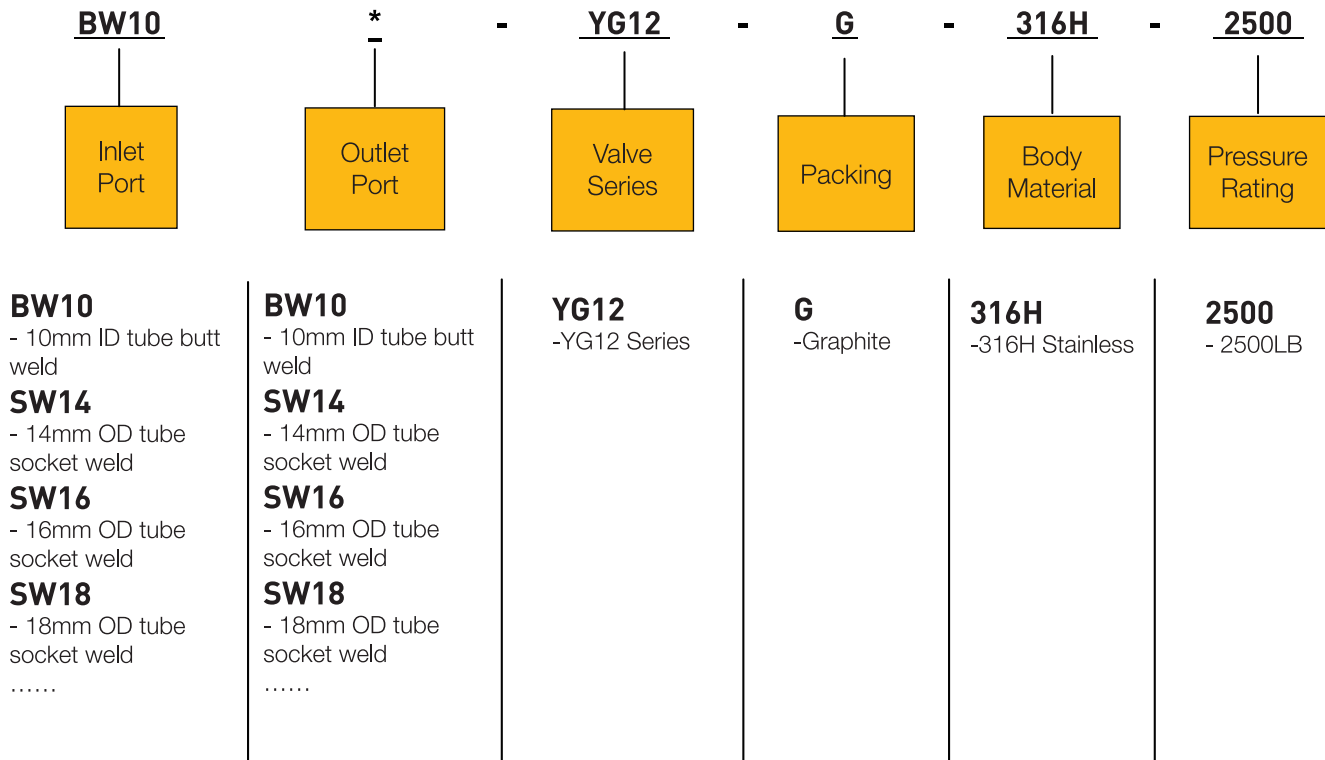

Other inlet / outlet requirements, please contact Parker Hannifin.

Ongoing product development may require changes to the details contained in this catalog from time to time. Parker Hannifin reserves the right to make such changes without notice. All dimensions shown in this catalog are approximate and subject to change.



 **WARNING**

FAILURE, IMPROPER SELECTION OR IMPROPER USE OF THE PRODUCTS AND/OR SYSTEMS DESCRIBED HEREIN OR RELATED ITEMS CAN CAUSE DEATH, PERSONAL INJURY AND PROPERTY DAMAGE.

This document and other information from Parker Hannifin Corporation, its subsidiaries and authorized distributors provide product and/or system options for further investigation by users having technical expertise. It is important that you analyze all aspects of your application and review the information concerning the product or system in the current product catalog. Due to the variety of operating conditions and applications for these products or systems, the user, through its own analysis and testing, is solely responsible for making the final selection of the products and systems and assuring that all performance, safety and warning requirements of the application are met.

The products described herein, including without limitation, product features, specifications, designs, availability and pricing, are subject to change by Parker Hannifin Corporation and its subsidiaries at any time without notice.

Parker Worldwide

Europe, Middle East, Africa

AE – United Arab Emirates, Dubai
Tel: +971 4 8127100
parker.me@parker.com

AT – Austria, Wiener Neustadt
Tel: +43 (0)2622 23501-0
parker.austria@parker.com

AT – Eastern Europe, Wiener Neustadt
Tel: +43 (0)2622 23501 900
parker.easteurope@parker.com

AZ – Azerbaijan, Baku
Tel: +994 50 2233 458
parker.azerbaijan@parker.com

BE/LU – Belgium, Nivelles
Tel: +32 (0)67 280 900
parker.belgium@parker.com

BG – Bulgaria, Sofia
Tel: +359 2 980 1344
parker.bulgaria@parker.com

BY – Belarus, Minsk
Tel: +375 17 209 9399
parker.belarus@parker.com

CH – Switzerland, Etoy
Tel: +41 (0)21 821 87 00
parker.switzerland@parker.com

CZ – Czech Republic, Klecany
Tel: +420 284 083 111
parker.czechrepublic@parker.com

DE – Germany, Kaarst
Tel: +49 (0)2131 4016 0
parker.germany@parker.com

DK – Denmark, Ballerup
Tel: +45 43 56 04 00
parker.denmark@parker.com

ES – Spain, Madrid
Tel: +34 902 330 001
parker.spain@parker.com

FI – Finland, Vantaa
Tel: +358 (0)20 753 2500
parker.finland@parker.com

FR – France, Contamine s/Arve
Tel: +33 (0)4 50 25 80 25
parker.france@parker.com

GR – Greece, Athens
Tel: +30 210 933 6450
parker.greece@parker.com

HU – Hungary, Budaörs
Tel: +36 23 885 470
parker.hungary@parker.com

IE – Ireland, Dublin
Tel: +353 (0)1 466 6370
parker.ireland@parker.com

IT – Italy, Corsico (MI)
Tel: +39 02 45 19 21
parker.italy@parker.com

KZ – Kazakhstan, Almaty
Tel: +7 7273 561 000
parker.easteurope@parker.com

NL – The Netherlands, Oldenzaal
Tel: +31 (0)541 585 000
parker.nl@parker.com

NO – Norway, Asker
Tel: +47 66 75 34 00
parker.norway@parker.com

PL – Poland, Warsaw
Tel: +48 (0)22 573 24 00
parker.poland@parker.com

PT – Portugal, Leca da Palmeira
Tel: +351 22 999 7360
parker.portugal@parker.com

RO – Romania, Bucharest
Tel: +40 21 252 1382
parker.romania@parker.com

RU – Russia, Moscow
Tel: +7 495 645-2156
parker.russia@parker.com

SE – Sweden, Spånga
Tel: +46 (0)8 59 79 50 00
parker.sweden@parker.com

SK – Slovakia, Banská Bystrica
Tel: +421 484 162 252
parker.slovakia@parker.com

SL – Slovenia, Novo Mesto
Tel: +386 7 337 6650
parker.slovenia@parker.com

TR – Turkey, Istanbul
Tel: +90 216 4997081
parker.turkey@parker.com

UA – Ukraine, Kiev
Tel: +380 44 494 2731
parker.ukraine@parker.com

UK – United Kingdom, Warwick
Tel: +44 (0)1926 317 878
parker.uk@parker.com

ZA – South Africa, Kempton Park
Tel: +27 (0)11 961 0700
parker.southafrica@parker.com

North America

CA – Canada, Milton, Ontario
Tel: +1 905 693 3000

US – USA, Cleveland
Tel: +1 216 896 3000

Asia Pacific

AU – Australia, Castle Hill
Tel: +61 (0)2-9634 7777

CN – China, Shanghai
Tel: +86 21 2899 5000

HK – Hong Kong
Tel: +852 2428 8008

IN – India, Mumbai
Tel: +91 22 6513 7081-85

JP – Japan, Tokyo
Tel: +81 (0)3 6408 3901

KR – South Korea, Seoul
Tel: +82 2 559 0400

MY – Malaysia, Shah Alam
Tel: +60 3 7849 0800

NZ – New Zealand, Mt Wellington
Tel: +64 9 574 1744

SG – Singapore
Tel: +65 6887 6300

TH – Thailand, Bangkok
Tel: +662 186 7000-99

TW – Taiwan, Taipei
Tel: +886 2 2298 8987

South America

AR – Argentina, Buenos Aires
Tel: +54 3327 44 4129

BR – Brazil, Sao Jose dos Campos
Tel: +55 800 727 5374

CL – Chile, Santiago
Tel: +56 2 623 1216

MX – Mexico, Apodaca
Tel: +52 81 8156 6000

19-10-B ING-EN-6P-YG

Parker Hannifin Instrumentation



ENGINEERING YOUR SUCCESS.