

HP50N

Hollow Hex Plug
SAE-ORB

SAE 090109B

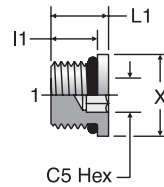

C5 - Across Internal Hex Flat

TUBE FITTING PART #	HOSE FITTING PART #	END SIZE 1 UN/UNF-2A	C5 HEX (in.)	I1 (in.)	L1 (in.)	X DIA (in.)	STANDARD Dynamic Pressure (x 1,000 PSI)		
							-S	-SS	-B
2 HP50N	05HP-2	5/16-24	1/8	0.30	0.40	0.44	6.0	6.0	
3 HP50N	05HP-3	3/8-24	1/8	0.30	0.40	0.50	6.0	6.0	
4 HP50N	05HP-4	7/16-20	3/16	0.36	0.47	0.56	6.0	6.0	
5 HP50N	05HP-5	1/2-20	3/16	0.36	0.47	0.63	6.0	6.0	
6 HP50N	05HP-6	9/16-18	1/4	0.40	0.50	0.69	6.0	6.0	
8 HP50N	05HP-8	3/4-16	5/16	0.44	0.58	0.88	6.0	6.0	
10 HP50N	05HP-10	7/8-14	3/8	0.50	0.65	1.00	6.0	6.0	
12 HP50N	05HP-12	1 1/16-12	9/16	0.59	0.77	1.25	6.0	6.0	
14 HP50N	05HP-14	1 3/16-12	9/16	0.59	0.77	1.38	5.5		
16 HP50N	05HP-16	1 5/16-12	5/8	0.59	0.77	1.50	5.5	5.5	
20 HP50N	05HP-20	1 5/8-12	3/4	0.59	0.77	1.88	4.0		
24 HP50N	05HP-24	1 7/8-12	3/4	0.59	0.77	2.13	3.0	3.0	

Dimensions and pressures for reference only, subject to change.

