



Ermeto Original

SWVE - banjo fittings **Programme broadening**

Chromium-6 Free



NEW!

All sizes can now be supplied! **Metallic and soft sealing!**

Parker Hannifin has enlarged its banjo fitting product programme. The SWVE is the ideal banjo fitting for low and medium pressure range applications, where a compact design, but with high flow characteristics, is required.

Technical characteristics

- Available in chromium6-free steel
- Diameters from 4LL to 42L and 6S to 38S
- Metric and inch stud threads
- Metallically sealed with DKA or soft sealed with KDS + O-Ring
- PN max. 160 bar

Advantages

- An economical soft-sealing banjo fitting
- Chromium6-free surface
- Excellent flow characteristics
- Compact design
- Complete range available



Parker Hannifin plc • Parker Sales UK
Tachbrook Park Drive • Tachbrook Park • GB-Warwick CV34 6TU
Tel: +44 1926 317 878 • Fax: +44 1926 317 855
<http://www.parker.com/uk>



DryTechnology

SWVE – banjo fitting
EO 24° connector/stud end
with metallic edge sealing ring

SWVE-KDS – banjo fitting
EO 24° connector/stud end
with soft sealing ring

Type A

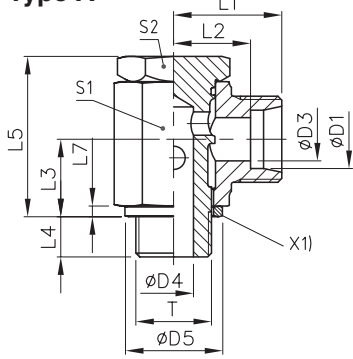

Type B

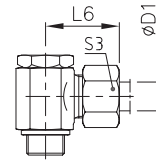
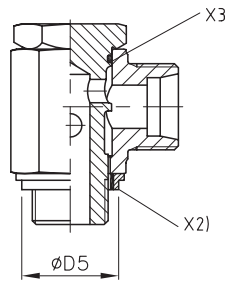

X1) sealing edge ring DKA
X2) sealing ring KDS
X3) O-ring OR

Technical characteristics

M: Metric stud thread

Series	D1	T	D3	D4	DKA D5	KDS D5	L1	L2	L3	L4	L5	L6	L7	S1	S2	S3	Weight g. per piece	Type A order code* metallically sealed	Type B order code* soft sealed	PN (bar)		
																				CF	A3C	
LL	04	M08X1	3.0	3.0	12.5	15	14.5	10.5	8.0	6	17.0	20	2.5	12	12	10	18	SWVE04LLMOMD		63	63	
	06	M10X1	4.5	5.0	14.0	15	15.5	10.0	10.0	6	21.0	22	2.5	14	14	12	29	SWVE06LLMOMD	SWVE06LLMKDSOMD	63	63	
	08	M10X1	6.0	5.0	14.0	15	16.5	11.0	10.0	6	21.0	23	2.5	14	14	14	31	SWVE08LLMOMD	SWVE08LLMKDSOMD	63	63	
L	06	M10X1.5	4.5	5.0	14.0	15	15.5	10.5	10.0	6	21.5	25	2.5	14	14	14	31	SWVE06LMOMD	SWVE06LMKDSOMD	160	160	
	08	M12X1.5	6.0	6.0	17.0	17	19.0	12.0	12.0	9	25.0	27	3.0	17	17	17	51	SWVE08LMOMD	SWVE08LMKDSOMD	160	160	
	10	M14X1.5	8.0	6.5	19.0	19	21.0	14.0	13.0	9	27.0	29	3.0	19	19	19	68	SWVE10LMOMD	SWVE10LMKDSOMD	160	160	
	12	M16X1.5	10.0	8.5	21.0	22	22.5	15.5	15.0	9	32.0	30	3.0	22	21	22	100	SWVE12LMOMD	SWVE12LMKDSOMD	100	100	
	15	M18X1.5	12.0	11.0	23.0	24	24.5	17.5	18.0	9	37.5	33	3.0	24	24	27	138	SWVE15LMOMD	SWVE15LMKDSOMD	100	100	
	18	M22X1.5	15.0	13.0	27.0	27	28.0	20.5	21.5	11	44.0	37	4.5	30	27	32	241	SWVE18LMOMD	SWVE18LMKDSOMD	100	100	
	22	M26X1.5	19.0	18.0	31.0	32	33.0	25.5	24.0	13	49.0	42	3.5	36	32	36	351	SWVE22LMOMD	SWVE22LMKDSOMD	100	100	
	28	M33X2	24.0	22.0	39.0	40	39.5	32.0	30.5	14	66.5	49	3.5	50	46	41		SWVE28LMOMD	SWVE28LMKDSOMD	100	100	
	35	M42X2	30.0	29.0	49.0	50	46.5	36.0	35.5	16	76.0	58	3.5	60	55	50		SWVE35LMOMD	SWVE35LMKDSOMD	100	100	
	42	M48X2	36.0	35.0	55.0	56	51.5	40.5	40.5	18	86.0	63	3.5	70	60	60		SWVE42LMOMD	SWVE42LMKDSOMD	100	100	
	S	06	M12X1.5	4.0	6.0	17.0	17	21.0	14.0	12.0	9	25.0	29	3.0	17	17	17	55	SWVE06SMOMD	SWVE06SMKDSOMD	160	160
		08	M14X1.5	5.0	6.5	19.0	19	22.0	15.0	13.0	9	27.0	30	3.0	19	19	19	75	SWVE08SMOMD	SWVE08SMKDSOMD	160	160
		10	M16X1.5	7.0	8.5	21.0	22	23.5	16.0	15.0	9	32.0	32	3.0	22	22	22	106	SWVE10SMOMD	SWVE10SMKDSOMD	100	100
		12	M18X1.5	8.0	11.0	23.0	24	24.5	17.0	18.0	9	37.0	33	3.0	24	24	24	134	SWVE12SMOMD	SWVE12SMKDSOMD	100	100
14		M20X1.5	10.0	10.0	25.0		28.0	20.0	18.0	11	37.0	38	3.0	27	27	27	179	SWVE14SMOMD		100	100	
16		M22X1.5	12.0	13.0	27.0	27	30.0	21.5	21.5	11	44.0	40	4.5	30	27	30	252	SWVE16SMOMD	SWVE16SMKDSOMD	100	100	
20		M27X2	16.0	18.0	32.0	33	35.0	24.5	24.0	13	49.0	46	3.5	36	32	36	363	SWVE20SMOMD	SWVE20SMKDSOMD	100	100	
25		M33X2	20.0	22.0	39.0	40	43.5	31.5	30.5	14	66.5	56	3.5	50	46	46		SWVE25SMOMD	SWVE25SMKDSOMD	100	100	
30		M42X2	25.0	29.0	49.0	50	50.5	37.0	35.5	16	76.0	64	3.5	60	55	50		SWVE30SMOMD	SWVE30SMKDSOMD	100	100	
38		M48X2	32.0	35.0	55.0	56	57.5	41.5	40.5	18	86.0	72	3.5	70	60	60		SWVE38SMOMD	SWVE38SMKDSOMD	100	100	

R: Inch stud thread

Series	D1	T	D3	D4	DKA D5	KDS D5	L1	L2	L3	L4	L5	L6	L7	S1	S2	S3	Weight g. per piece	Type A order code* metallically sealed	Type B order code* soft sealed	PN (bar)		
																				CF	A3C	
LL	04	G 1/8A	3.0	5.0	14	15	15.5	11.5	10.0	6	21.0	21	2.5	14	14	10	28	SWVE04LLROMD	SWVE04LLRKDSOMD	63	63	
	06	G 1/8A	4.5	5.0	14	15	15.5	10.0	10.0	6	21.5	22	2.5	14	14	12	28	SWVE06LLROMD	SWVE06LLRKDSOMD	63	63	
	08	G 1/8A	6.0	5.0	14	15	16.5	11.0	10.0	6	21.0	23	2.5	14	14	14	30	SWVE08LLROMD	SWVE08LLRKDSOMD	63	63	
L	06	G 1/4A	4.0	5.0	14	15	17.5	10.5	10.0	6	21.0	25	2.5	14	14	14	31	SWVE06LROMD	SWVE06LRKDSOMD	160	160	
	08	G 1/4A	6.0	6.5	18	19	20.0	13.0	13.0	9	27.0	28	3.0	19	19	17	65	SWVE08LROMD	SWVE08LRKDSOMD	160	160	
	10	G 1/4A	8.0	6.5	18	19	21.0	14.0	13.0	9	27.0	29	3.0	19	19	19	66	SWVE10LROMD	SWVE10LRKDSOMD	160	160	
	12	G 3/8A	10.0	8.5	22	22	22.5	15.5	15.0	9	32.0	30	3.0	22	22	22	102	SWVE12LROMD	SWVE12LRKDSOMD	100	100	
	15	G 1/2A	12.0	11.0	26	27	26.0	19.0	18.0	11	37.5	34	4.5	27	27	27	171	SWVE15LROMD	SWVE15LRKDSOMD	100	100	
	18	G 1/2A	15.0	13.0	26	27	28.0	20.5	21.5	11	44.0	37	4.5	30	27	32	249	SWVE18LROMD	SWVE18LRKDSOMD	100	100	
	22	G 3/4A	19.0	18.0	32	33	33.0	25.5	24.0	13	49.0	42	3.5	36	32	36	349	SWVE22LROMD	SWVE22LRKDSOMD	100	100	
	28	G1A	24.0	22.0	39	40	39.5	32.0	30.5	14	66.5	49	3.5	50	46	41		SWVE28LROMD	SWVE28LRKDSOMD	100	100	
	35	G11/4A	30.0	29.0	49	50	46.5	36.0	35.5	16	76.0	58	3.5	60	55	50		SWVE35LROMD	SWVE35LRKDSOMD	100	100	
	42	G11/2A	36.0	35.0	55	56	51.5	40.5	40.5	18	86.0	63	3.5	70	60	60		SWVE42LROMD	SWVE42LRKDSOMD	100	100	
	S	06	G 1/4A	4.0	6.5	18	19	22.0	15.0	13.0	9	27.0	30	3	19	19	17	69	SWVE06SROMD	SWVE06SRKDSOMD	160	160
		08	G 1/4A	5.0	6.5	18	19	22.0	15.0	13.0	9	27.0	30	3	19	19	19	73	SWVE08SROMD	SWVE08SRKDSOMD	160	160
		10	G 3/8A	7.0	8.5	22	22	23.5	16.0	15.0	9	32.0	32	3	22	22	22	108	SWVE10SROMD	SWVE10SRKDSOMD	100	100
		12	G 3/8A	8.0	8.0	22	22	24.5	17.0	18.0	9	37.0	33	3	24	24	24	147	SWVE12SROMD	SWVE12SRKDSOMD	100	100
14		G 1/2A	10.0	11.0	26	27	28.0	20.0	18.0	11	37.0	38	4.5	27	27	27	177	SWVE14SROMD	SWVE14SRKDSOMD	100	100	
16		G 1/2A	12.0	13.0	26	27	30.0	21.5	21.5	11	44.0	40	4.5	30	27	30	249	SWVE16SROMD	SWVE16SRKDSOMD	100	100	
20		G 3/4A	16.0	18.0	32	33	35.0	24.5	24.0	13	49.0	46	3.5	36	32	36	359	SWVE20SROMD	SWVE20SRKDSOMD	100	100	
25		G1A	20	22	39	40	43.5	31.5	30.5	14	66.5	56	3.5	50.0	46.0	46.0		SWVE25SROMD	SWVE25SRKDSOMD	100	100	
30		G11/4A	25	29	49	50	50.5	37	35.5	16	76.0	64	3.5	60.0	55.0	50.0		SWVE30SROMD	SWVE30SRKDSOMD	100	100	
38		G11/2A	32	35	55	56	57.5	41.5	40.5	18	86.0	72	3.5	70.0	60.0	60.0		SWVE38SROMD	SWVE38SRKDSOMD	100	100	

New Types Delivery without nut and ring.

Information on ordering complete fittings or alternative sealing materials see Technical Handbook 4100, page 17. Please add the suffixes below according to the material/surface required.

Order code suffixes

Type	Material	Suffix surface	Example	Standard sealing material (no additional suffix needed)
Type A	Steel, zinc plated, chromium6-free	CF	SWVE16SROMDCF	
	Steel, zinc plated, yellow chromated	A3C	SWVE16SROMDA3C	
Type B	Steel, zinc plated, chromium6-free	CF	SWVE16SRKDSOMDCF	NBR
	Steel, zinc plated, yellow chromated	A3C	SWVE16SRKDSOMDA3C	NBR

